

**WATER TECH**<sup>TM</sup>

---

**POOL BLASTER® MAX**

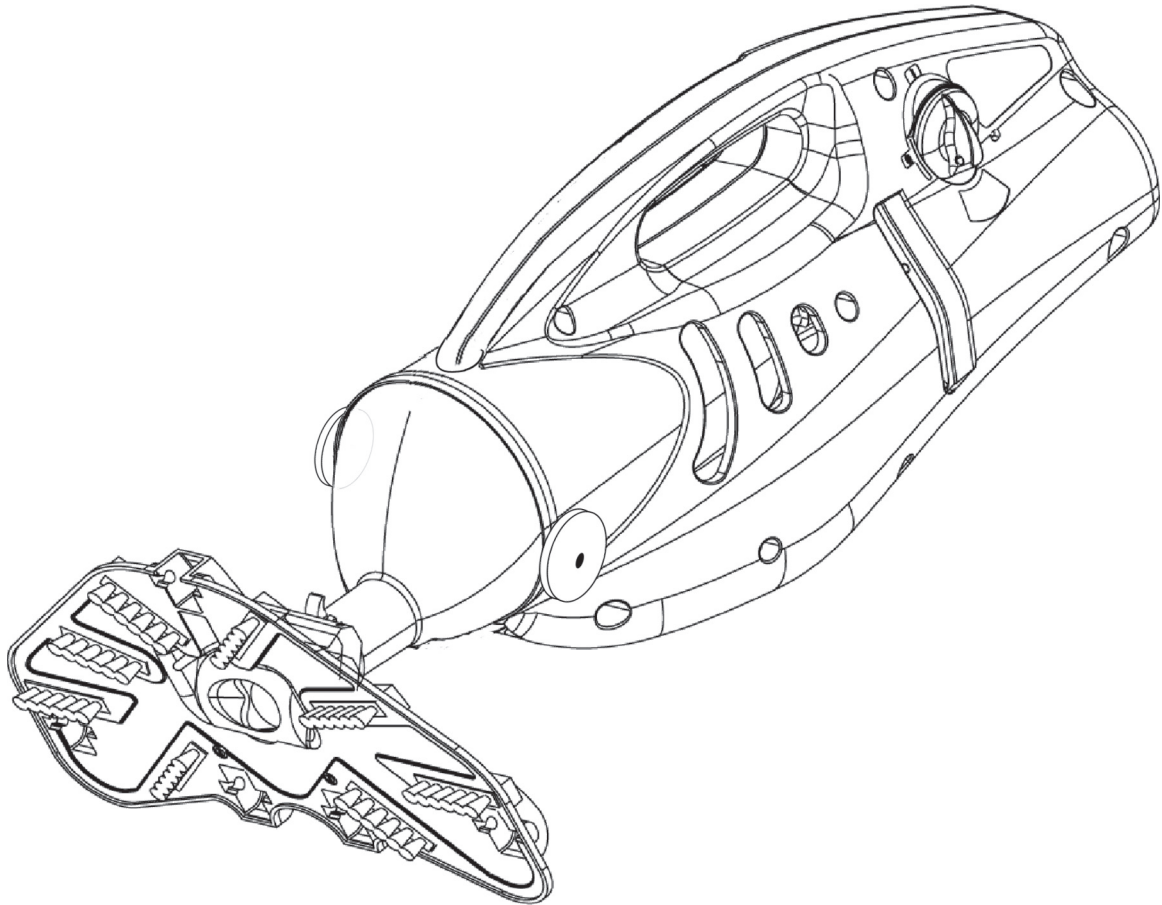

**Handheld Pool & Spa Cleaner  
Use and Care Manual**

***IMPORTANT: DO NOT RETURN THIS PRODUCT TO THE STORE***

Should you have any problems or questions concerning your product you should contact Water Tech's Customer Service Division toll free in the U.S. at

**1-800-298-8800** or via fax at **1-800-488-0700**

or via the web **at [www.PoolBlaster.com](http://www.PoolBlaster.com)**

## **Warning**

This device complies with Part 15 of the FCC Rules. Operation is subject to the following two conditions: (1) This device may not cause harmful interference, and (2) this device must accept any interference received, including interference that may cause undesired operation.

NOTE: This equipment has been tested and found to comply with the limits for a Class B digital device, pursuant to Part 15 of the FCC Rules. These limits are designed to provide reasonable protection against harmful interference in a residential installation. This equipment generates, uses and can radiate radio frequency energy and, if not used in accordance with the instructions, may cause harmful interference to radio communications. However, there is no guarantee that interference will not occur in a particular installation. If this equipment does cause harmful interference to radio or television reception, which can be determined by turning the equipment off and on, the user is encouraged to try and correct the interference by one or more of the following measures:

- Reorient or relocated the receiving antenna.
- Increase the separation between the equipment and receiver.
- Connect the equipment into an outlet on a circuit different than that to which the receiver is connected.
- Consult the dealer or an experienced radio/TV technician for help.

NOTE: Changes or modifications not expressly approved by the party responsible for compliance could void the user's authority to operate the equipment.

# Before Initial Use

CONGRATULATIONS on your purchase of a top-quality Water Tech product which has been thoroughly tested to meet our exacting quality control standards.

The Pool Blaster vacuum is powered by Nickel-Metal Hydride batteries. These batteries will operate at their peak after the second or third charge. A precise amount of space is left open in the Pool Blaster body to properly ventilate and cool the batteries, seals and drive system.

Please take care to tighten the On/Off knob when turning the unit on and before you submerge the unit in water to prevent any water from entering the motor box. From time to time, water may enter the motor box. To drain any water that may enter the motor box, allow all the water to drain from the exterior vacuum area than remove the On-Off Knob and turn the machine so the knob is towards the floor and tilt side to side in all directions. The amount of water may be very small or not noticed at all.

If water has entered the motor box area use a blow dryer on warm setting to dry any moisture build-up on the inside of the motor box. Water entering the Pool Blaster body presents no safety hazard and should be drained occasionally to avoid any chance of long-term corrosion. The batteries and motor in the Pool Blaster are long lasting and proper care will help to prolong the life of your appliance.

These guidelines and safeguards help insure that your new Pool Blaster operates effectively. Please read all instructions carefully before using your Pool Blaster. Please take a few moments to review the following IMPORTANT INFORMATION before using this tool.

# SERVICE & IMPORTANT SAFEGUARDS

## Service Information

**⚠ WARNING:** Any repairs requiring disassembly should be performed by a Water Tech Authorized Service Center. For repairs please go to [www.watertechcorp.com](http://www.watertechcorp.com) for more information or call 1-800-298-8800.

**⚠ WARNING:** To reduce the risk of fire, electrical shock, injury, or damage to your machine:

- ⚠** Do not use if unit is damaged in any way.
  - ⚠** Use this product only for its intended use as described in this manual. Use only Water Tech accessories and filters.
  - ⚠** Never leave your Pool Blaster plugged in for long term storage.
  - ⚠** NEVER LEAVE YOUR Pool Blaster IN WATER WHEN IT IS "OFF" OR HAS RUN OUT OF BATTERY POWER.
  - ⚠** Do not use your Pool Blaster for pool openings; the Pool Blaster is designed for general maintenance of your pool or spa.
  - ⚠** The Pool Blaster is designed for underwater use only. Do not attempt to use your Pool Blaster to clean anything other than your pool or spa. It is not intended for use as an all-purpose vacuum cleaner.
  - ⚠** Close supervision is necessary when used near children. Do not allow this vacuum cleaner to be used as a toy.
  - ⚠** This vacuum creates suction. Keep hair, loose clothing, fingers, and all parts of body away from openings and moving parts.
  - ⚠** Unit must be submerged in water to operate properly.
  - ⚠** When not in use, store the Pool Blaster indoors in a clean, dry place. Do not leave underwater, in direct sunlight, or exposed to extreme temperatures.
  - ⚠** You can operate the Pool Blaster without its vacuum head attachment, but when using the vacuum head attachment, make sure that either the supplied wheels or brushes are inserted in place.
  - ⚠** Do not use without filter bag/seal ring and nose cap in place.
  - ⚠** Replace damaged filter bag/seal ring promptly.
  - ⚠** Avoid picking up hard, sharp objects with the vacuum. They may damage the vacuum and the filter bag.
  - ⚠** Do not use to pick up toxic substances, flammable or combustible liquids such as gasoline, or operate in the presence of explosive or flammable fumes.
  - ⚠** Never insert or drop any object into any opening on the device. Keep all openings free of leaves, rocks, or anything that may reduce water flow.
- Do not use on or near hot surfaces.

- ⚠** Use extra care when cleaning on stairs.
- ⚠** Make sure the Pool Blaster is unplugged from the charger and in the "off" position before cleaning, filter change or any other routine maintenance.
- ⚠** While Pool Blaster is charging, do not handle with wet hands or without shoes.
- ⚠** Only use the charger supplied to recharge this vacuum. Do not use the supplied charger with any other appliance.
- ⚠** To protect against risk of electrical shock, do not put charger in water or other liquid.
- ⚠** To avoid damage to the charger and cord, never carry the charger by the cord or yank to disconnect from an outlet. Instead, firmly grasp the charger body and pull to disconnect. Do not pull cord around sharp edges or corners.
- ⚠** Do not allow the cord to hang over the edge of a table or counter or touch hot surfaces.
- ⚠** Do not operate with a damaged cord or charger.
- ⚠** Do not use or store charger outdoors. Charge your Pool Blaster indoors in a clean, dry place. Do not expose charger to rain, or extreme temperatures.
- ⚠** For best results, operate the charger in a location where the temperature is more than 50 degrees F but less than 100 degrees F.
- ⚠** Disconnect charger from power supply when not in use, and before any routine cleaning or maintenance.
- ⚠** The use of extension cords is not recommended. Plug the charger into a properly grounded standard electrical outlet (120v/60Hz US, 240 volts, 50Hz International) only.
- ⚠** If vacuum cleaner is not working as it should, or has been dropped or damaged in any way, return it to a service center before using. Call 1-800-298-8800 for a center nearest you.
- ⚠** This product contains a sealed nickel-metal hydride battery. Do not incinerate battery as it will explode at high temperatures. Always dispose of the battery in accordance with your state law.
- ⚠** Leaks from a battery cell can occur under extreme conditions. If the battery liquid gets on the skin, wash immediately with water. If it gets in your eyes, immediately flush your eyes with a mild solution of baking soda and water and seek medical attention.

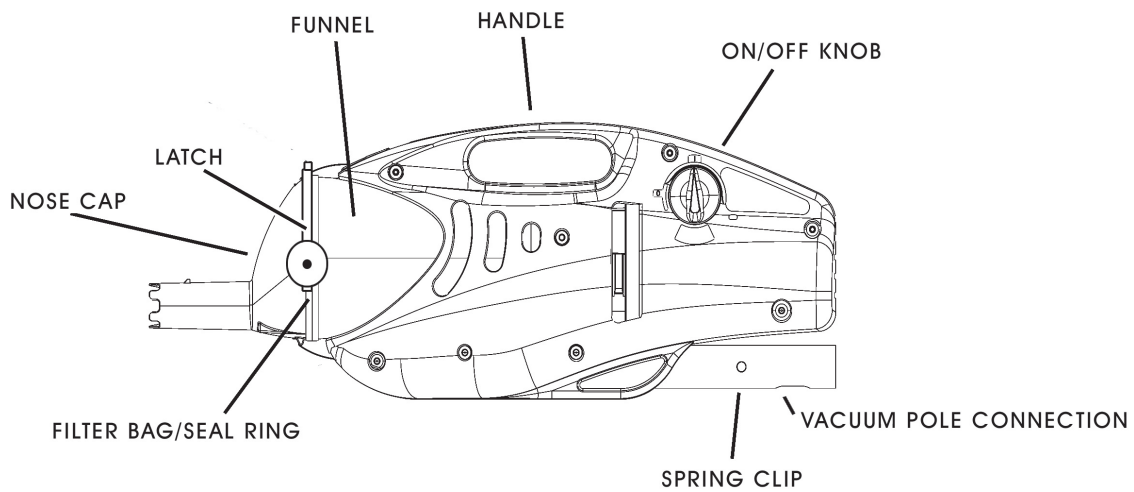
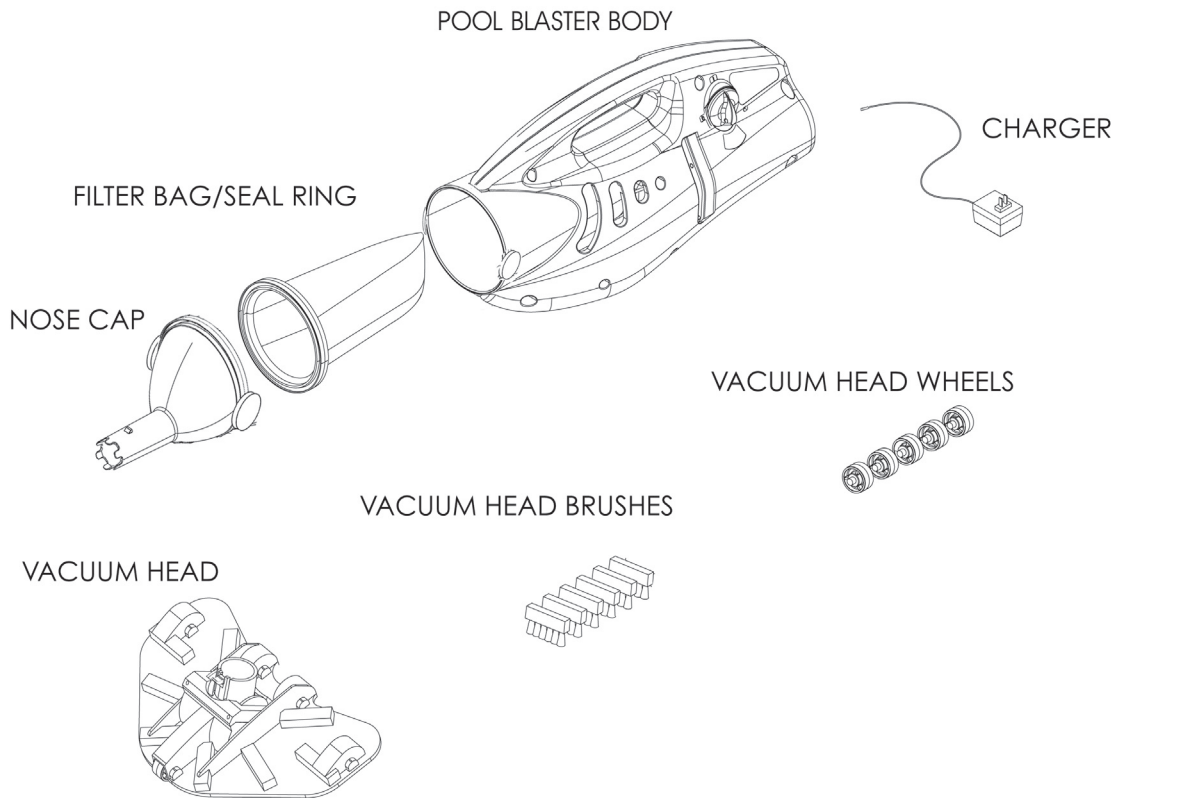

ITEM No.	DESCRIPTION	PART No.	QTY.	ADDITIONAL PARTS AVAILABLE FOR PURCHASE
1	Vacuum Head	PBA006	1	Sand & Silt bag (part No. PBW022SS)
2	Vacuum Head Brushes	PBW049	6	Microfilter Bag (part No. PBW022MF), to be used in conjunction with the Sand & Silt bag
3	Vacuum Head Wheels	PBW050	5	Shallow Water Hose Attachment (part No. PBASHA)
4	Nose Cap	PBA002	1	* U.S. Charger (part No. PBA099L)
5	All Purpose Filter Bag w/ Seal Ring	PBW022AP	1	* European 230V Charger (part No. WT3843)
6	Pool Blaster	PBA005	1	
7	Battery Charger	PBA099*	1	To purchase, contact your retailer or call us at (800)298-8800 or see us on the web at <a href="http://www.PoolBlaster.com">www.PoolBlaster.com</a>
8	Spring Clip	PBW041	1	

## Charging the Battery Pack

### PRECAUTIONS:

- *Make sure power supply is normal household voltage, 120 volts, 60 Hz (240 volts, 50Hz International), AC only.*
- *Do not handle Pool Blaster while charging with wet hands or without shoes.*
- *Do not use or store your charger outdoors. Charge battery indoors in a clean dry place. For best results, your Pool Blaster battery should be charged in a location where the temperature is above 50 ° F and below 100° F.*
- *Only use the charger supplied to recharge this vacuum. Do not use the supplied charger with any other appliance or damage may occur.*
- *Disconnect Pool Blaster from power charger when not in use.*
- *Unplug the charger from outlet before any routine cleaning or maintenance.*
- *The use of extension cords is not recommended. Plug the charger into a properly grounded standard electrical outlet (120v/60Hz US, 240 volts, 50Hz International) only.*
- *To protect against risk of electrical shock, do not put unit charger in water or other liquid.*
- *To avoid damage to the charger and cord, never carry the charger by the cord or yank to disconnect from an outlet. Instead, firmly grasp the charger body and pull to disconnect. Do not pull cord around sharp edges or corners.*
- *Do not allow the cord to hang over the edge of a table or counter or touch hot surfaces. The vacuum should be placed or mounted away from such hot surfaces.*

### Charging The Battery Pack For The First Time

Only charge the Pool Blaster with the charger provided with the unit. The charger provided is specially designed for the Pool Blaster.

Please note that the Battery Pack for your Pool Blaster has been shipped in a low voltage condition.

**You must charge the Pool Blaster Battery Pack for 12 Hours Before Initial Use**

## TO RECHARGE THE CLEANER

1. Turn the knob counterclockwise to remove the On-Off Knob. This will expose the charging jack connection.  
NOTE: When removing the On/Off knob it is normal to hear air escaping. The air inside has simply expanded from being heated by the motor.
2. Connect the lead plug from the charger to the charging jack on the Pool Blaster.
3. Connect the charger to the appropriate electrical outlet. The Pool Blaster should be re-charged for 10 - 12 hours.
4. After charging, ensure that the On-Off knob is fully secure and turned to the "On" position before attempting to use your Pool Blaster.
5. The ON-OFF knob should remain disconnected from the unit and left hanging from the attached lanyard until the unit is ready to be used.

**Do Not leave the unit plugged into the charger for more than 24 hours.**

**CAUTION:** Replace the ON-OFF knob tightly before placing the Pool Blaster in water. Placing the Pool Blaster in water without tightening the ON-OFF knob so that the unit is "ON" will void your warranty.

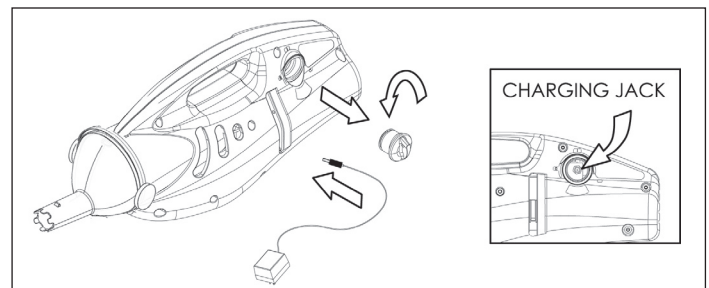
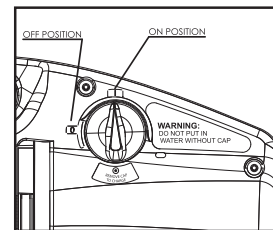

## BATTERY LIFE

- Your battery pack should give you many hours of use. If the motor, batteries or charger stop working, please review the warranty information and/or read the Commonly Asked Questions.
- The batteries are factory sealed in the motor box, and CANNOT BE REPLACED. Do not attempt in any way to destroy or disassemble the motor box or any of its components. Under no circumstances should you attempt to open the battery pack and replace the batteries yourself.



## PREPARING THE VACUUM HEAD / INSERTING THE FILTER BAG

## SETTING UP YOUR POOL BLASTER FOR USE

### Inserting Wheels and Brushes in the Vacuum Head

Your Pool Blaster has been configured with wheels and brushes at the factory in a manner which we have found perform best in most swimming pool applications.

Vac Head with Wheels  
and Brushes as provided  
with you Pool Blaster

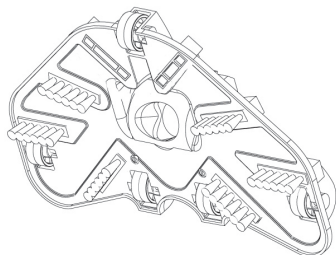

Should you wish to experiment with different configurations you can refit the head with just wheels or just brushes with the Front Wheel.

Vac Head  
with Wheels  
only

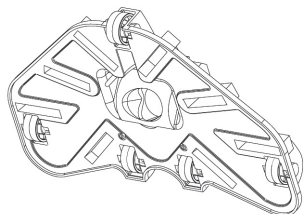

Vac Head  
with Brushes  
and Front  
Wheel only

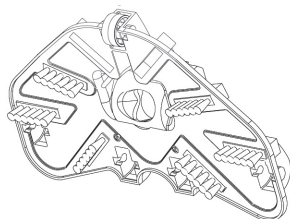

NOTE: Inserting the wheels into the vacuum head may require a good deal of force. If you have trouble, you may find it easier to insert them by placing the wheel on a hard surface and pushing down on the head.

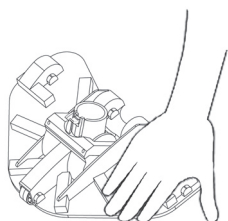

**⚠ CAUTION:** Wheels OR Brushes with Front Wheel must be installed prior to use. Water Tech is NOT responsible for damages to your pool if neither the wheels nor brushes with Front Wheel are installed in the vacuum head before use.

### Inserting the Filter Bag and Nose Cap

- Place the Pool Blaster on its end on a stable and secure surface.
- Place the filter bag/seal ring (part no.PBW022AP) into the Pool Blaster, as shown in diagram. Make sure the rubber seal ring sits on the funnel. All of the filter bag must be inside the funnel to ensure the head closes fully.
- Close the latch squeezing the filter bag/seal ring in between.
- Never use the Pool Blaster without the filter bag properly installed. This will damage the impeller and void the warranty

NOTE: You should not need to apply excessive force in order to close the latch. If you have trouble, make sure the filter bag is not between the seal and the nose cap or funnel and there are no other obstructions such as sand.

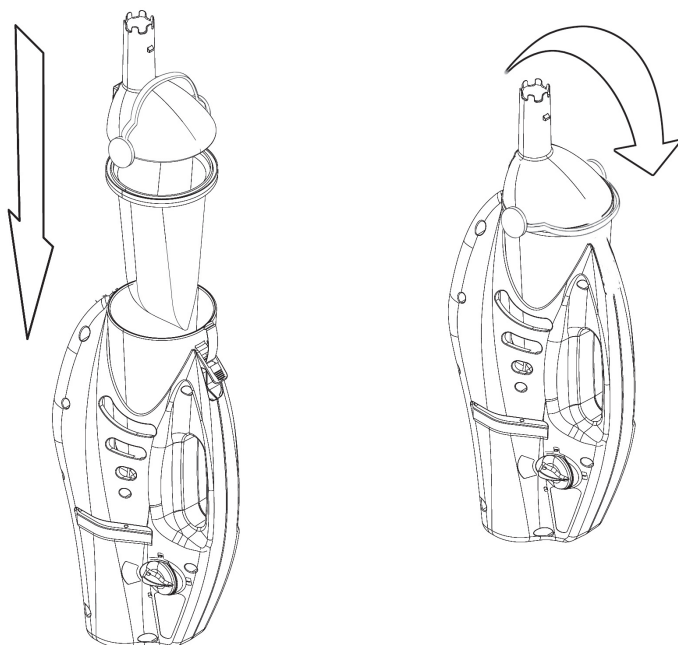

# HOW TO USE YOUR POOL BLASTER

**CAUTION:** The Pool Blaster is designed for under water use only.

## OPERATING TEMPERATURES

Unit must be submerged in water to operate properly. Maximum operating temperature is between +5°C (41°F) and +40°C (104°F). Maximum operating depth is (15 ft).

Your Pool Blaster is designed for use in 3 different ways to vacuum your pool or spa:

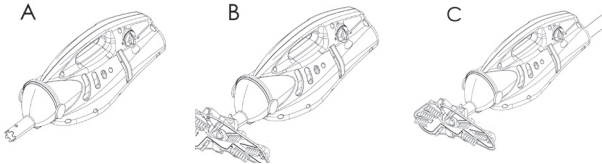

- A. Vacuum using the handle and the vacuum head removed.
- B. Vacuum using the handle and attached vacuum head, with either wheel or brush attachments depending on pool type.
- C. Vacuum using a standard pool accessory pole (not supplied) with the attached vacuum head.

**Caution:** Vacuum Head must be used when using a pole.

## Choosing the Proper Filter Bag

### Standard All-Purpose Filter Bag

The Pool Blaster, with its Standard Filter Bag is intended for routine pool maintenance only. Should there be an excessive amount of debris (ie. when opening the pool for the season, cleaning following major storm activity or other high level debris occurrences) be aware that you will have to empty the Filter Bag much more often than normal. It may take several cleaning and recharging cycles to clean your pool.

### Microfilter Bag

The Microfilter Bag should only be used to remove fine sand, silt, algae and other small particles from your pool. Be aware that due to the high degree of filtration that this bag affords. It fills much more rapidly than the All-Purpose bag and therefore must be emptied frequently during pool cleaning to insure optimum performance.

**WARNING:** Never use your Pool Blaster without the filter bag/seal ring and nose cap properly in place. Doing so will VOID the warranty.

## Using a standard pool pole

The pole attachment on your Pool Blaster is designed to accommodate any standard pole. To attach a pole, simply press down on the alignment pins on the pole retaining spring clip. Aligning the holes, slide the pole onto the Pool Blaster and release the clip.

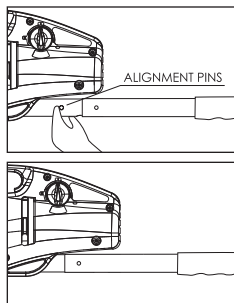

**WARNING:** Do not lean on pole or use pole to support weight.

Once your Pool Blaster is set-up for use, you may put it in your pool or spa.

- Bring your Pool Blaster to the side of the Pool or Spa and turn it on by turning the On-Off knob all the way to the "On" position. This must be done outside of the water before it is submerged.
- Once the Pool Blaster is "On" it can be completely submerged in water and is ready for use.
- This appliance is designed to be in water only when in the "ON" position and has battery power. Excessive leaking can occur when not running and void the warranty. Never leave your Pool Blaster in the water when it is off.

**NOTE:** There are two ways to remove the unit from the pool:

**WHEN USING HANDLE:** Lift from pool with the nose facing up to allow the water to escape from the back and sides.

**WHEN USING A POOL POLE:** Remove the unit from the pool with the bottom facing upwards and the handle facing down. This will allow the water to escape and keep the dirt inside

## Cleaning the reusable filter bags

For maximum cleaning efficiency the filter bag/seal ring should be checked, emptied, and cleaned after each use or whenever you notice the performance of your Pool Blaster declining.

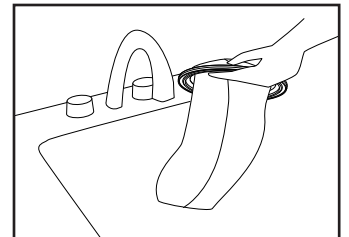

## To clean the filter bag

- Unplug the Pool Blaster from the charging outlet before changing the filter or performing any other routine maintenance.
- Place the Pool Blaster on its end (remove the vacuum pole, if attached).
- Unlatch the nose cap
- Remove the filter bag/seal ring by pulling it out of the funnel.
- Invert the filter bag/seal ring, shake out the large debris and rinse with a garden hose or in a sink. Note: Do not clean in a washing machine or with detergent.
- Re-insert the filter bag when finished.
- Note: Your reusable filter bag should be replaced if the seal ring is worn or if the bag is torn.



## Important Tips:

- Store your Pool Blaster in a clean, dry place when not in use. Do not leave it underwater, in direct sunlight, or exposed to extreme heat or cold.
- You may clean the Pool Blaster body with soap and water. Avoid using solvents when cleaning plastic parts. Most plastics are susceptible to damage from various types of commercial solvents and may be damaged by their use. Use clean cloths or paper towels to remove dirt, dust, oil, grease etc.
- The On-Off knob should be periodically lubricated with a silicon-based grease
- The ON/OFF knob should remain disconnected from the unit and left hanging from the attached lanyard until the unit is ready to be used.

 **CAUTION:** Do not at any time let brake fluids, gasoline, petroleum-based products, penetrating oils, etc. come in contact with plastic parts. They contain chemicals that can damage, weaken, or destroy plastic.

 **WARNING:** Do not attempt to modify this tool or create accessories not approved for use with this tool. Any such alteration or modification is misuse and could result in a hazardous condition leading to possible serious injury. The batteries and motor are factory sealed in the motor box, and CANNOT BE REPLACED. Do not attempt in any way to destroy or disassemble motor box or any of its components. Instead, take your Pool Blaster to an authorized service center. Failure to follow these instructions may void your warranty agreement.

- General maintenance of your Pool Blaster requires you occasionally clean off the O-rings on the "ON-OFF" knob and add silicone lubricant/sealant. This will ensure easier turning and a water-tight seal. This lubricant is available at your local pool & spa or hardware retailer.
- In the Nose Cap (Part No. PBA002) there is a Flapper Valve. To keep the Nose Cap Flapper Valve moving freely, clean the valve after every use. This will help to keep dirt inside the Pool Blaster after the cleaner is removed from the pool.

## Service Information

**NOTE:** Any repairs requiring disassembly must be performed by a Water Tech Authorized Service Center. For the repair center nearest you call us toll free at 1-800-298-8800. Unauthorized repairs will void the warranty.

## Storing the Pool Blaster

**NOTE:** State of the art Nickel-Metal Hydride batteries power the Pool Blaster. These are the same batteries used in many portable phones. In order to properly ventilate and cool the batteries and drive system a certain amount of space is left open in the Pool Blaster body. As a result, from time to time, water may enter the unit. In order to allow for any water to be drained you should remove the On-Off Knob after each use, turn the machine so the knob is towards the floor and tilt side to side in all directions. The amount of water may be very small or not noticed at all. After removing any water use a blow dryer on warm setting to dry any moisture build-up on the inside of the motor box. Water entering the Pool Blaster body presents no safety hazard and should be drained to avoid any chance of long-term corrosion. The batteries and motor in the Pool Blaster are long lasting and proper care will help to prolong the life of your appliance.

**NOTE:** Remove Pool Blaster from charger before storage.

When not in use, your Pool Blaster should be stored indoors, in a clean dry location sheltered from direct sunlight, extreme temperatures and rain. Do not store the Pool Blaster in a garage or anywhere the unit could freeze. Storing the Pool Blaster in areas of high humidity can affect battery performance over time.

The ON/OFF knob should remain disconnected from the unit and left hanging from the attached lanyard until the unit is ready to be used.

For your convenience the Pool Blaster has an oval opening in the pool pole adaptor on which you can hang the unit.

## Long Term Storage

Follow the above storage instructions and unplug the charger from the electrical outlet.

Your Pool Blaster should be charged once a month during long-term storage to maintain the battery pack. DO NOT leave the Pool Blaster charging for a period of more than 24 hours.

When charging for the first time after long-term storage, your Pool Blaster may take 2-3 uses before maximum performance is achieved.

The ON/OFF knob should remain disconnected from the unit and left hanging from the attached lanyard until the unit is ready to be used.

## LIMITED WARRANTY

Water Tech Corp ("WT") warrants this product, including supplied accessories against defects in material or workmanship for the time periods as set forth below. Pursuant to this Limited Warranty WT will, at its option (i) repair the product to the original specifications or (ii) replace the product with a new or refurbished product. In the event of a defect, these are your exclusive remedies. For purposes of this Limited Warranty, "refurbished," means a product or part that has been returned to its original specifications.

**All Pool Blaster Battery Powered Pool & Spa Vacuums.** For a period of one (1) year from the original date of purchase of the product, WT will, at its option, repair or replace with new or refurbished product or parts, any product or parts determined to be defective.

**Accessories.** Included accessories are covered by this Limited Warranty for a period of 90 Days.

**Instructions.** Please retain the original box and internal packaging materials. To obtain warranty service, you must comply with the following requisite instructions:

- (1) Visit Water Tech Corp's Customer Support Department at [www.wtrma.com](http://www.wtrma.com). You will be guided through the correct process on how to obtain the required RMA# (Return Merchandise Authorization Number.) All customers must obtain an RMA number before any product will be accepted for warranty service. If you need additional assistance please contact us by telephone: (800-298-8800) or email: [customerservice@watertechcorp.com](mailto:customerservice@watertechcorp.com).
- (2) Package the unit with all accessories properly and securely in the original box.
- (3) Attach your RMA number and Bar-Code you received from the website to the outside of the package. If you could not print the RMA number and bar-code from the website you must write your RMA number in thick black indelible marker on two sides of the box.
- (4) Send the package by USPS or express courier of choice to: Water Tech Corp. 44 West Ferris Street, East Brunswick, New Jersey 08816; (WT suggests you insure the contents of your package.) WT is not responsible for lost, stolen or damaged property in transit to WT.

**Repair/Replacement Warranty.** This Limited Warranty shall apply to any repair, replacement part or replacement product for the remainder of the original Limited Warranty period or for ninety (90) days, whichever is longer. Any parts or products replaced shall become the property of WT.

This Limited Warranty covers only product issues caused by defects in material or workmanship during ordinary consumer use; it does not cover product issues caused by any other reasons, including but not limited to product issues caused by commercial use, acts of God, misuse, abuse, limitations in technology, or modification of or to any part of the WT product. This Limited Warranty does not cover WT products sold AS IS or WITH ALL FAULTS or consumables (such as batteries). This Limited Warranty is invalid if the factory-applied serial number has been altered or removed from the product. This Limited Warranty is valid only in the United States and Canada.

**EXPRESS LIMITATION:** THIS LIMITED WARRANTY ONLY APPLIES IF THE PRODUCT WAS PURCHASED FROM AN AUTHORIZED WATER TECH DEALER; THIS WARRANTY IS NOT TRANSFERABLE.

**LIMITATION ON DAMAGES.** WT WILL NOT BE LIABLE FOR ANY INCIDENTAL OR CONSEQUENTIAL DAMAGES FOR BREACH OF EXPRESSED OR IMPLIED WARRANTY ON THIS PRODUCT.

**DURATION OF IMPLIED WARRANTIES.** EXCEPT TO THE EXTENT PROHIBITED BY LAW APPLICABLE LAW, ANY IMPLIED WARRANTY OF MERCHANTABILITY OR FITNESS FOR A PARTICULAR PURPOSE ON THIS PRODUCT IS LIMITED IN DURATION OF THIS WARRANTY.

Some states do not allow the exclusion or limitation of incidental or consequential damages, or allow limitations on how long an implied warranty lasts, so the above limitations or exclusions may not apply to you. This Limited Warranty gives you specific legal rights and you may have other rights, which vary from state to state.

## COMMON QUESTIONS

**Q: The ON-OFF knob has become difficult to turn. What can I do?**

A: Clean off the O-rings and add silicone lubricant/sealant. This will ensure easier turning and a better water tight seal. Refer to the maintenance section for more information.

**Q: Can my Pool Blaster be run out of water?**

A: Yes, for a short period of time when you turn it on before submerging in your pool or spa or when removing it from the pool or spa..

**Q: When I am cleaning my pool how do I know when the Pool Blaster is out of battery power?**

A: Most people can feel the Pool Blaster is running through vibration in the vacuum pole or handle. To be sure you can lift it out of the water to hear if it is running or not.

**Q: How often should I clean out my Pool Blaster filter bag?**

A: You can clean your filter bag as often as you like with no ill effects. The filter bag can then be turned inside out and rinsed with a hose or in a sink. Do not wash it in a washing machine or with detergent. For more detailed instructions, see "Cleaning Your Pool Blaster" instructions in this manual.

*For best results, do this after each use, or whenever you notice the performance of your Pool Blaster declining.*

**Q: Is it normal for me to hear air escaping out of the Pool Blaster when I open the On-Off knob?**

A: Yes, the powerful motor heats the air in the motor box, which then expands, creating the air sound.

**Q: How can I stop dirt from coming out of the nozzle when I take the cleaner out of the water?**

A: There are two ways to remove the unit from the pool when done cleaning:  
WHEN USING HANDLE: Lift from pool with the nose facing up to allow the water to escape from the back and sides.  
WHEN USING A VACUUM POLE: Remove the unit from the pool with the bottom facing upwards and the handle facing down. This will allow the water to escape and keep the dirt inside.

**Q: How can I prevent sand and silt from escaping through the filter bag?**

A: The Pool Blaster comes standard with an all-purpose filter bag. A Sand and Silt bag (Part No. PBW022SS) or a Microfilter bags are available. To purchase contact your retailer or see our website at [www.PoolBlaster.com](http://www.PoolBlaster.com).

**Q: What if I put the Pool Blaster in the pool without the On-Off Knob in place?**

A: Do not operate your Pool Blaster if water gets inside the machine. Put the Pool Blaster on its side to drain the water out of the knob hole and tilt side to side to get the water out.

Do not use for at least 24 hours. If possible, you can speed the drying process with a blow dryer. To avoid serious injury or damage, do not replace the knob or attempt to charge or operate your Pool Blaster until it is completely dry.

**Q: Can I leave my Pool Blaster on the charger all the time?**

A: After charging is complete, the Pool Blaster and charger should be removed from the outlet. This will prevent over-charging and prolong the life of your battery pack. **IMPORTANT:** Disconnect the charger before storing your Pool Blaster.

**Q: Can I replace the batteries myself?**

A: Under no circumstances should you attempt to open the motor housing or battery housing. The batteries and motor are factory installed and sealed, and your rechargeable battery should give you many hours of use. If your motor, batteries, or charger stop working, take the Pool Blaster to an authorized service center.

**Q: Where can I buy replacement parts?**

A: Look for original Water Tech replacement parts at your local retailer or on the web at [www.PoolBlaster.com](http://www.PoolBlaster.com).

**Q: Will my pool chemicals hurt the Pool Blaster?**

A: The Pool Blaster is designed to withstand pool chemicals during its usage period. However, it should be rinsed off with fresh water after it is removed from the pool. This will increase the life of the filter bag/seal ring.

**Q: Can I leave the Pool Blaster in the pool when not in use?**

A: No. The Pool Blaster should be removed from the pool and stored in a clean, dry place when not in use. This will increase the life of your Pool Blaster and its accessories.

**Q: What do I do if my Pool Blaster does not vacuum?**

A: Make sure your Pool Blaster is completely submerged in the water and the air is out of the clear funnel. The cleaner is only designed to vacuum water and will not vacuum air. If that does not resolve your situation please check the following:

- Make sure the filter bag is clear of debris that may be obstructing the flow.
- Make sure the Pool Blaster knob is in the 12 o'clock "ON" position.
- Charge your Pool Blaster for at least 12 hours.

If none of the above help resolve the situation, please call our Customer Service Division at

**1-800-298-8800.**

or see us on the web at

**[www.PoolBlaster.com](http://www.PoolBlaster.com)**

**IMPORTANT: DO NOT RETURN THIS PRODUCT TO THE STORE**

Should you have any problems or questions concerning your product you should contact Water Tech's Customer Service Division toll free in the U.S. at

**1-800-298-8800** or via fax at **1-800-488-0700**

or via the web **at [www.PoolBlaster.com](http://www.PoolBlaster.com)**

Water Tech Corp  
44 West Ferris St.  
East Brunswick, NJ 08816  
USA

Toll Free: 1-800-298-8800 (US only)

Email: [support@WaterTechCorp.com](mailto:support@WaterTechCorp.com)  
[www.WaterTechCorp.com](http://www.WaterTechCorp.com)