

Nature²[®] Fusion Soft Electrolytic Cell Assembly Replacement Kit

WARNING

FOR YOUR SAFETY - This product must be installed and serviced by a contractor who is licensed and qualified in pool equipment by the jurisdiction in which the product will be installed where such state or local requirements exist. In the event no such state or local requirement exists, the maintainer must be a professional with sufficient experience in pool equipment installation and maintenance so that all of the instructions in this manual can be followed exactly. Before installing this product, read and follow all warning notices and instructions that accompany this product. Failure to follow warning notices and instructions may result in property damage, personal injury, or death. Improper installation and/or operation will void the warranty.

Improper installation and/or operation can create unwanted electrical hazard which can cause serious injury, property damage, or death.

These instructions are to be used with the following Zodiac Replacement Kits:

R0502800 -- Nature² Fusion Soft 700 Electrolytic Cell Assembly Replacement Kit

R0503000 -- Nature² Fusion Soft 1400 Electrolytic Cell Assembly Replacement Kit

This document gives instructions for installing the Nature² Fusion Electrolytic Cell Assembly.

For technical assistance, please contact our Technical Support Department at (800) 822-7933. All of the instructions must be followed exactly. Read through these instructions completely before starting the procedure.

WARNING

Do not operate electrolytic cell without proper flow or water circulation. A buildup of flammable gases would result in hazardous conditions which could lead to fire or explosion.

To reduce the risk of electric shock, fire or injury, service should only be attempted by a qualified Pool Service Professional.

When using electrical products, basic precautions should always be followed, including the following:

- **DANGER: RISK OF ELECTRIC SHOCK WHICH CAN RESULT IN SERIOUS INJURY OR DEATH.** Before attempting installation or service, ensure that all power to the device is disconnected/turned off at the circuit breaker.
- Grounding is required. The unit should be installed by a qualified service representative and should be properly grounded.
- Install to permit access for servicing.
- **Before attempting any electrical wiring, be sure to read and follow Safety Instructions in the Installation and Operation Manual. Wiring should only be attempted by a qualified professional.**

WARNING

To avoid personal injury when working with pool chemicals, always wear rubber gloves and eye protection, cover exposed skin, and work in a well ventilated area. Use caution when choosing a location to open and use chemicals as they may damage any surface into which they come in contact. If any chemical gets on your skin, rinse the area immediately with water. If any chemical gets on your clothing, immediately remove the piece of clothing and rinse with water.

1. Electrolytic Cell Replacement

1. Unplug the DC cord from electrolytic cell. See Figure 1.

WARNING

Always turn pump off prior to installing or removing any components from the pool's plumbing. Your pump/filter system is operated under pressure and pressure must be released before you begin to avoid system damage or personal injury. Open the air relief valve on your pool filter to release the pressure in the system.

2. Run the pool pump and filter for five (5) minutes. After this time turn off the pool pump.



3. Close valves between filter and pool to prevent pool draining.
4. Unplug the DC cable from the electrolytic cell. See Figure 1.
5. Turn the large collar counterclockwise to remove and save for reinstallation.
6. Remove the O-ring and discard.
7. Remove the existing the electrolytic cell from the vessel.
8. Install the O-ring provided in the kit. Make sure the O-ring is seated properly.

IMPORTANT

Make sure the O-ring is secure in the groove on the vessel top, not on the underside of the cap.

9. Install the new electrolytic cell into the vessel.
10. Hand tighten the large collar. Do not over tighten.
11. Plug the DC cable into the electrolytic cell. Press cable down firmly onto ports.
12. Reset valves and switches. Turn pump and sanitizer on. Wait five (5) minutes for system to go through its diagnostics.
13. Confirm chlorine output and settings on the user interface.
14. For operating instructions, please refer to the Nature² Fusion Soft Installation and Operation Manual, originally supplied with the product.

2. Parts List

The following table is for your reference. To order additional parts, please contact your local distributor.

DESCRIPTION	R0502800	R0503000
Electrolytic Cell Assembly	1	1
O-Ring, Large Collar	1	1
Instructions	1	1

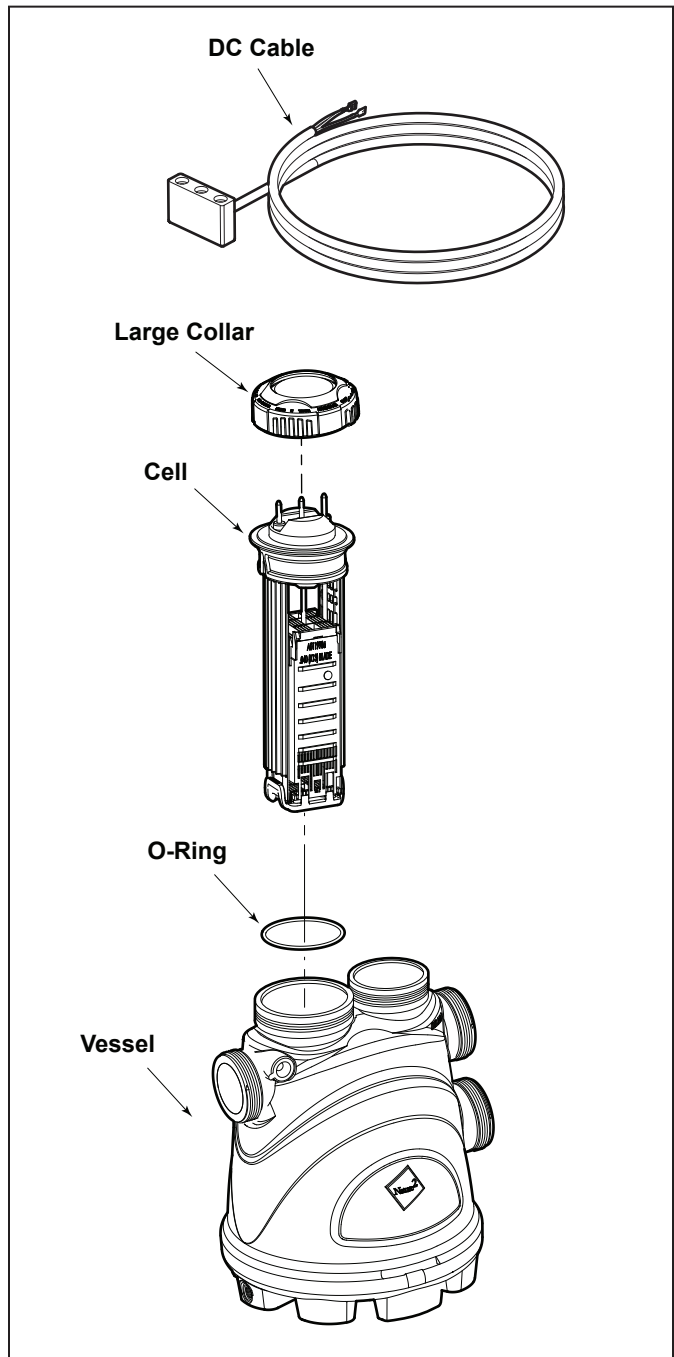

Figure 1. Installation of the Electrolytic Cell Assembly



ZODIAC POOL SYSTEMS, INC.

6000 Condor Drive • Moorpark, CA • 93021
Tel: 800-822-7933 • Fax: 877-327-1403